

# GEMINI QUADRAT

wood-aluminium windows

The Gemini Quadrat systems have distinctive profile edges, with the sash shifted away from the frame and thus creating two distinct surfaces. The Quadrat is distinguished by its minimalistic and geometrical design, crucial in modern architecture where glass, concrete, aluminium and steel is the standard. Its uniqueness is further magnified by the lack of a visible slant, resulting in a right angle visible on the surface of Quadrat profiles.



## SYSTEM FEATURES

Welded corner connections



Crimped corner connections



Wood section thickness 68–92 mm



Glazing thickness 24–64 mm



Sash and frame profile bending



## STRAIGHT/SIMPLE LINES AND GEOMETRIC SHAPES

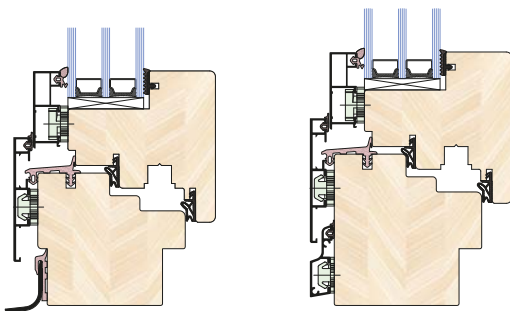
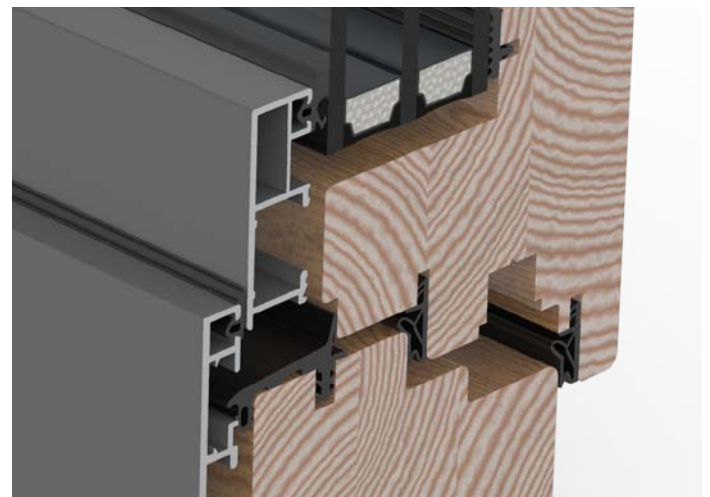

Heat transfer  $U_w$  coefficient for sample window 1.23x1.48 [m]

$U_w$ [W/(m <sup>2</sup> K)]		Pine ( $\lambda=0,13$ [W/(mK)]; $\rho=500$ [kg/m <sup>3</sup> ])				Meranti ( $\lambda=0,12$ [W/(mK)]; $\rho=450$ [kg/m <sup>3</sup> ])				Spruce ( $\lambda=0,11$ [W/(mK)]; $\rho=450$ [kg/m <sup>3</sup> ])			
		68 [mm]	78 [mm]	88 [mm]	92 [mm]	68 [mm]	78 [mm]	88 [mm]	92 [mm]	68 [mm]	78 [mm]	88 [mm]	92 [mm]
Glazing 4/16/4	$U_g=1,1$ [W/(m <sup>2</sup> K)]	1,256	1,226	1,203	1,195	1,232	1,204	1,181	1,173	1,208	1,180	1,158	1,151
	$U_g=1,0$ [W/(m <sup>2</sup> K)]	1,194	1,164	1,141	1,133	1,171	1,142	1,119	1,111	1,147	1,119	1,097	1,090
Glazing 4/16/4/16/4	$U_g=0,7$ [W/(m <sup>2</sup> K)]	0,964	0,931	0,905	0,896	0,942	0,909	0,884	0,876	0,919	0,887	0,863	0,855
	$U_g=0,5$ [W/(m <sup>2</sup> K)]	0,841	0,807	0,781	0,773	0,819	0,786	0,761	0,752	0,795	0,764	0,739	0,731